

# 1x3 Fused Hybrid PM Fiber Standard Tap

## Features

- Low Excess Loss
- High Extinction Ratio
- High Power Handling
- Available for Slow or Fast Axis Operation
- Telcordia GR-1221 Compliant Test

## Application

- Optical Amplifier
- Power Monitoring
- Telecomm Systems
- Test Equipment



## Specifications

Parameter	Unit		Premium	A grade	Premium	A grade
Port Configuration			1x3			
Central Wavelength <sup>1</sup>	nm	-	633, 780, 830, 980, 1064		1310, 1480, 1550	
Bandwidth	nm	-	±20			
Excess Loss	dB	Typ.	0.5	0.7	0.3	0.4
Excess Loss	dB	Max	0.7	0.9	0.5	0.8
PER for Through Port <sup>2</sup>	dB	Min	18	15	20	17
Return Loss <sup>3</sup>	dB	Min	50	45	50	45
Directivity	dB	Min	55			
Operating Power	W	Max	2			
Operating Temperature	°C	-	-40 ~ +85			
Storage Temperature	°C	-	-50 ~ +85			
Package Type	mm	-	S6/S12/M2			

\* All specifications are before connectors. PER is 2dB lower and EL is 0.2dB higher after connectors

<sup>1</sup> Central wavelength can be customized for different applications

<sup>2</sup> Above PER is for more than 10%(CR) port, it's 2dB lower for no more than 10%(CR) port, and 4dB lower for no more than 5%(CR) port.

<sup>3</sup> Test at central wavelength only.

## Splitting Ratio & Its Tolerance

Splitting Ratio	Maximum Splitting Ratio Tolerance (%)			
	Premium		A Grade	
	Main Port	Tap Port	Main Port	Tap Port
0.5 / 99 / 0.5	± 0.4	± 0.2	± 0.5	± 0.3
1 / 98 / 1	± 0.6	± 0.4	± 0.8	± 0.5
2.5 / 95 / 2.5	± 1.5	± 0.8	± 1.8	± 1.0
5 / 90 / 5	± 2.0	± 1.2	± 2.5	± 1.3
10 / 80 / 10	± 2.5	± 1.5	± 3.0	± 1.8

## Fiber Type

	Common Port	Through Port	Coupling Port 1	Coupling Port 2
Type 1	Panda Fiber	Panda Fiber	SM28e or Equivalent Fiber	SM28e or Equivalent Fiber
Type 2	Panda Fiber	Panda Fiber	HI 1060 or Equivalent Fiber	HI 1060 or Equivalent Fiber
Type 3	Panda Fiber	Panda Fiber	HI 1060 or Equivalent Fiber	Panda Fiber
Type 4	Panda Fiber	Panda Fiber	SM28e or Equivalent Fiber	Panda Fiber

## Package dimension

S6

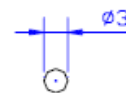
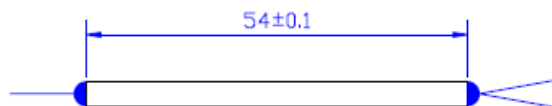

S12

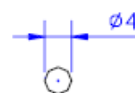
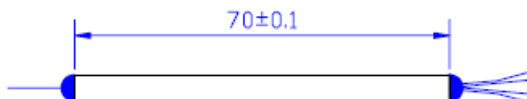

**M2**  
**Alloy Aluminum**

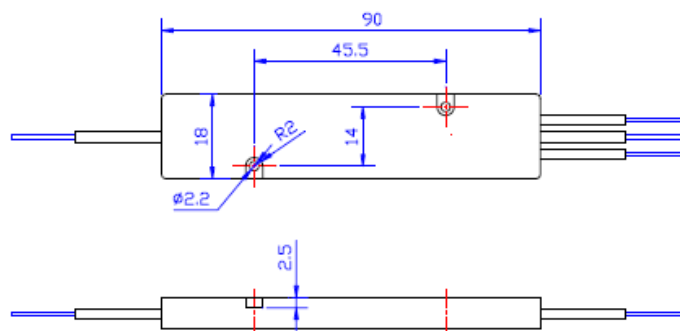

## Ordering Information

**PMST** —

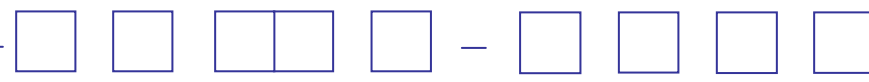

Wavelength	Structure	Splitting Ratio	Grade
4 - 1550 nm 5 - 1480 nm 7 - 1310 nm 8 - 1064nm 9 - 980nm B - 633nm L - 780nm K - 830nm	3 - 1x3	99 - 0.5: 99:0.5 98 - 1: 98:1 95 - 2.5:95:2.5 90 - 5: 90:5 80 - 10:80:10	P - Premium A - A grade

Package	Fiber Type	Fiber Length	Connector
5 - S6 with 250µm bare fiber B - S12 with 0.9mm loose tube E - M2 with 3mm cable	1 - Type 1 2 - Type 2 3 - Type 3 4 - Type 4	0 - 0.5m 1 - 0.75m 2 - 1.0m	0 - None 1 - FC/PC 2 - FC/SPC 3 - FC/APC 7 - FC/UPC

## Contact Information

For more information about BATi's' leadership in photonics devices, visit our website at [www.bostonati.com](http://www.bostonati.com).

To obtain additional technical information or to place an order for this product, please contact us at:

Phone: 1-781-935-2800

Fax: 1-781-935-2860

E-mail: [sales@bostonati.com](mailto:sales@bostonati.com)