

# 1x2 (2x2) Fused Hybrid PM Fiber Standard Tap

## Features

- Low Excess Loss
- High Extinction Ratio
- High Power Handling
- Available for Slow or Fast Axis Operation
- Telcordia GR-1221 Compliant Test

## Application

- Optical Amplifier
- Power Monitoring
- Telecomm Systems
- Test Equipment



## Specifications

Parameter	Unit		Premium	A grade	Premium	A grade
Port Configuration			1x2 or 2x2			
Central Wavelength <sup>1</sup>	nm	-	633, 780, 830, 980, 1064		1310, 1480, 1550	
Bandwidth	nm	-	±20			
Excess Loss	dB	Typ.	0.4	0.6	0.2	0.3
Excess Loss	dB	Max	0.6	0.8	0.3	0.5
PER for Through Ports <sup>2</sup>	dB	Min	20	17	20	17
Return Loss <sup>3</sup>	dB	Min	50	45	30	45
Directivity	dB	Min	55			
Operating Power	W	Max	2			
Operating Temperature	°C	-	-40 ~ +85			
Storage Temperature	°C	-	-50 ~ +85			
Package Type	mm	-	S6/S8/M1			

\* All specifications are before connectors. PER is 2dB lower and EL is 0.2dB higher after connectors

<sup>1</sup> Central wavelength can be customized for different applications

<sup>2</sup> Above PER is for more than 10%(CR) port, it's 2dB lower for no more than 10%(CR) port, and 4dB lower for no more than 5%(CR) port.

<sup>3</sup> Test at central wavelength only.

## Splitting Ratio & Its Tolerance

Splitting Ratio	Maximum Splitting Ratio Tolerance (%)	
	Premium	A Grade
99.5 / 0.5	± 0.2	± 0.3
99 / 1	± 0.4	± 0.5
98 / 2	± 0.6	± 0.8
95 / 5	± 1.5	± 1.8
90 / 10	± 2.0	± 2.5
80 / 20	± 2.5	± 3.0

## Fiber Type

	PM Fiber Port	SM Fiber Port
Type 1	Panda Fiber	SM28e or Equivalent Fiber
Type 2	Panda Fiber	HI 1060 Fiber
Type 3	Panda Fiber	OFS 980-20 Fiber
Type 4	Panda Fiber	OFS 980-16 Fiber

## Package dimension

S6

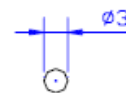
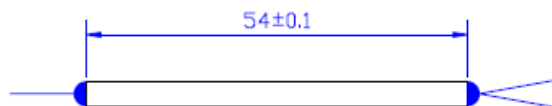

S8

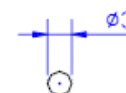

**M1  
ABS**

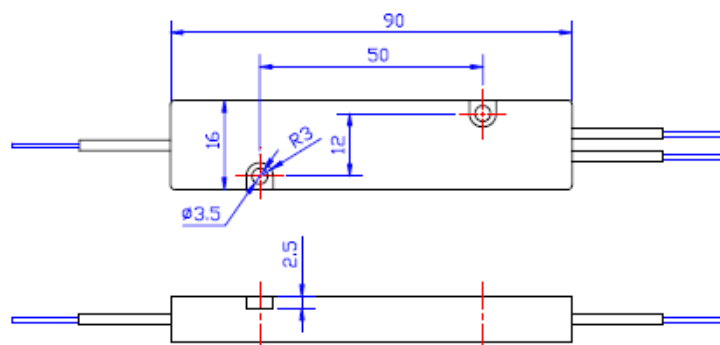

## Ordering Information

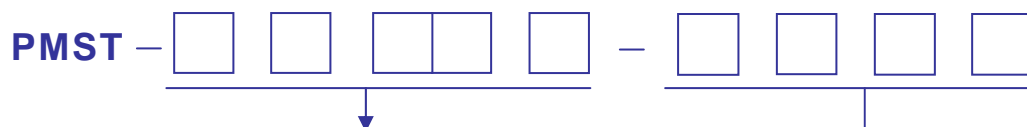

Wavelength	Structure	Splitting Ratio	Grade
4 - 1550 nm 5 - 1480 nm 7 - 1310 nm 8 - 1064nm 9 - 980nm B - 633nm L - 780nm K - 830nm	1 - 1x2 2 - 2x2	05 - 99.5:0.5 99 - 99:1 98 - 98:2 95 - 95:5 90 - 90:10 80 - 80:20	P - Premium A - A grade

Package	Fiber Type	Fiber Length	Connector
5 - S6 with 250µm bare fiber 7 - S8 with 0.9mm loose tube D - M1 with 3mm cable	1 - Type 1 2 - Type 2 3 - Type 3 4 - Type 4	0 - 0.5m 1 - 0.75m 2 - 1.0m	0 - None 1 - FC/PC 2 - FC/SPC 3 - FC/APC 7 - FC/UPC

## Contact Information

For more information about BATi's leadership in photonics devices, visit our website at [www.bostonati.com](http://www.bostonati.com).

To obtain additional technical information or to place an order for this product, please contact us at:

Phone: 1-781-935-2800

Fax: 1-781-935-2860

E-mail: [sales@bostonati.com](mailto:sales@bostonati.com)